

ASHTON HALL

LANCASTER



TECH SPECIFICATION

CONTENTS

Location & Local area	3
Venue	5
General Information	6
Company Management	7
Parking, Get en Route	8
Ashton Hall: Stage, Lighting, Sound, Video	9
Dimensions & Plans	14

Location & Local Area

Lancaster Town Hall sits at the cultural heart of the city of Lancaster.

Since opening in 1909 Lancaster Town Hall had been a centre of creative energy, a space for performance, celebration, and artistic exchange, whilst also playing a leading role in connecting audiences with culture across the city and beyond.



Proud of its heritage, Lancaster Town Hall looks outward, hosting music, theatre and dance performances of local, national, and international significance for and with a diverse community. At the heart of its vision is the belief that creative experiences of the highest quality should be open and accessible to all. Through an ambitious and varied programme, Lancaster Town Hall shares culture not only within its walls but also, across Lancaster and into the wider region.

Situated on the River Lune, the city of Lancaster is rich with history and creativity. From the iconic Lancaster Castle and the city's Georgian architecture to a thriving independent arts scene and the world-class research of Lancaster University, the city is a place where heritage and innovation work hand in hand.

Lancaster's relatively compact size is one of its strengths: people know each other, making collaboration natural and networks strong. A large and vibrant student population ensures a constant flow of energy and ideas, helping to reinvent and reshape the city for tomorrow.

With its annual festivals, galleries, historic venues, and proximity to both the Lake District and the Yorkshire Dales, Lancaster is not only an attractive city to visit but also, to live, work, and study in.

Venue

Company: Lancaster City Council
Address: Lancaster Town Hall
Dalton Square
Lancaster
LA1 1PJ

Phone: 01524 582226
Box Office: TBC
Website: www.lancaster.gov.uk/sites/lancaster-town-hall/the-ashton-hall

General Contact: events@lancaster.gov.uk

How to find us:

Lancaster is well connected by road and rail with excellent transport links across the North West and beyond.

Bus: Lancaster Bus Station is less than a 10 minute walk from Lancaster Town Hall. Local bus services stop throughout the city centre, making access straightforward.

Train: Lancaster Town Hall is around a 15 minute walk from Lancaster Railway Station, with regular direct services from Preston, Manchester, London, Glasgow, and other major cities. Visit nationalrail.com for more information

Car: Lancaster Town Hall is easily accessible from the M6 motorway (Junctions 33 and 34). Lancaster Town Hall does not have its own car park but, there are several nearby including Parksafes on China Street and St Nicholas Arcade. Blue Badge spaces are available close to the venue. Please visit www.lancaster.gov.uk/parking for detailed information.

General Information

Smoking/Vaping: Smoking and/or vaping is not permitted anywhere in the building, including on stage as part of a performance.

Wi-Fi: There is Wi-Fi throughout the building, no password is required.

Electrical Testing: If you are bringing electrical equipment to Lancaster Town Hall, you will be expected to have proof of recent portable appliance electrical tests (PAT) upon request.

Health & Safety: All visiting companies are expected to provide relevant risk assessments and method statements for their production or event and cooperate with us to ensure Lancaster Town Hall's Health and Safety Policy is upheld. If we determine that our Health and Safety Policy is not being upheld, we reserve the right to stop or change work activities as required.

Staffing: Staffing details will be agreed by contract on an event-by-event basis. To comply with our Health and Safety policy, there must always be a member of technical staff present as duty cover and not otherwise engaged in show operation. Any additional staff required should be discussed in advance and will be recharged at the rate specified in the contract.

Backstage: Lancaster Town Hall is a busy venue, with multiple residents working within it, and they may be sharing facilities.

Company Management

Backstage and Security: Lancaster Town Hall has a secure backstage area with access via doors using a swipe-card access pass system. There are a limited number of visitor passes available and it may not be possible to supply everyone with a pass in cases of larger companies. Lancaster Town Hall does not operate a manned stage door, but the Main Reception is staffed during opening hours and can provide backstage access.

Deliveries: Please clearly mark any deliveries with the name of your production or event. Deliveries will be available from the Main Reception, or from the Facilities Team (located in the basement) depending on the size of the item.

Company Facilities: There are 2 dressing rooms with enough space to accommodate 24 people (there are no on-site shower facilities). There is no provision for laundry on site.

Parking, Get en Route

Parking: There are minimal provisions for parking at Lancaster Town Hall. Single vehicles and small vans may be parked by prior arrangement. Trailers and heavy goods vehicles will need to be removed immediately after the get-in, get-out, or following any delivery.

Get-ins, Get-outs: Space to load and unload is via a private road accessed off of Nelson Street. If your transport is any larger than a long wheelbase or Luton van, please discuss your logistics with us in advance.

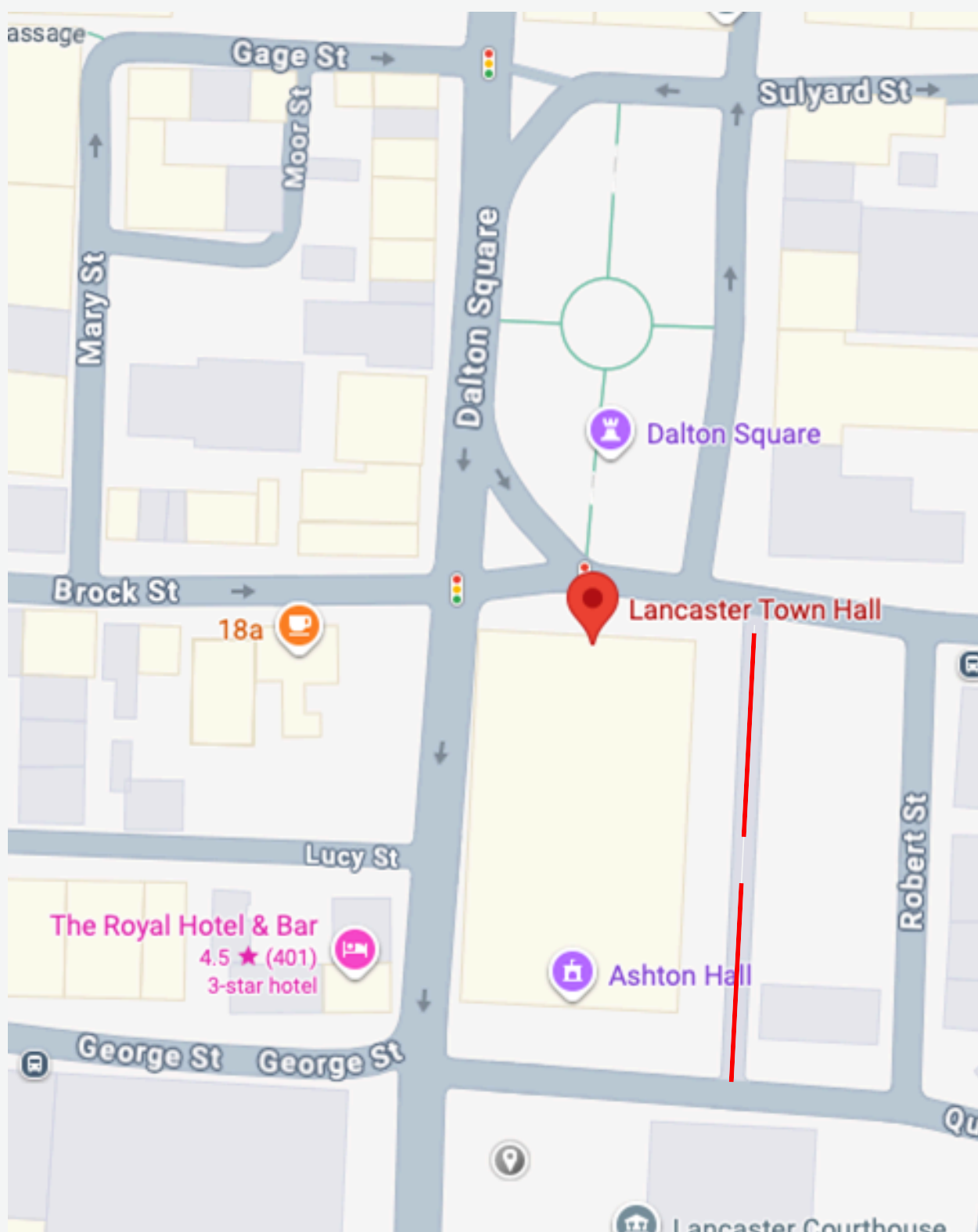

*Red line marks private road for load in. Please contact us if you require access.

Ashton Hall

The Ashton Hall is the main performance space in the building, providing a maximum capacity of 1200 people.



Stage

General Information: Some stock may not be available due to production commitments and some stock may be chargeable. Please check availability before arrival.

Stage Floor: Softwood over timber joints. (Downstage half of stage is made up of Prolyte lite deck sections) Fixings **not** permitted.

Stage Dimensions: Width: 1.09m
Depth: 1.24m
Height: 2m

Stage is access via stairs set either side of the stage,

Get-in Access: Ashton Hall is located on the first floor. Access is either by staircase or a goods lift.

Lift Dimensions and Capacity:

Configuration & Capacities:

Standing: 1200

Seated: 750 (including the balcony)

Cabaret: 250 (25 tables of 10)

Green Room: The Ashton Hall has a green room located behind the stage with access to both the stage door and the main hall.



Lighting

General Information: Some stock may not be available due to production commitments, and some stock may be chargeable. Please check availability before arrival. Additional fixtures can be hired in but all costs will be passed on.

Console & Dimming:

Console: Avolites Quartz | 2048 Channels | Software: Titan

Dimming: There are no dimmers in house stock. All stock is LED

Houselights: 5 large chandeliers, hung down centre of the room.

(Not under DMX control or dimmable)

Power Distribution:

3PH: 63A TPNE | SR Stage

Distribution: 3 x 32/1A, 6 x 16 / 1A

1PH: 32A PNE | SL Balcony

Distribution: 4 x 16/1A

1PH: 32A PNE | SR Balcony

Distribution: 4 x 16/1A

Various 13amp sockets can be found round the venue and on stage.

Lighting Fixtures: All stock is rigged. Any movement or refocus of the house rig must be corrected during your get-out.

Fixture	Quantity	Notes
ETC ColorSource V Spot	8	50 Deg. Lens Tube
ETC ColorSource Par DB	12	

Sound

General Information: Some stock may not be available due to production commitments, and some stock may be chargeable. Please check availability before arrival. Additional fixtures can be hired in but all costs will be passed on.

Power: 3 x 32amp stage power, can be converted to 16a or 13a if required. 13amp power located at FoH. General 13amp can also be found around the stage.

Console: Allen & Health SQ-6

Stage Box: Allen & Health GX4816 (48 inputs, 16 outputs)

Standard System Config: The system is patched as a L+R, Sub (mono), Fill (mono). All processing is done via the amps. Access to these by prior request only.

	Speakers	Amp (Channel)	Notes
Main L+R:	2 x Fohhn PT-70 (90 Deg.)	Fohhn D4.2000 (Amp 4) Ch. 2 & 4	One per side (stacked on top of subs)
Subs (L+R)	4 x Fohhn PS-800	Fohhn D4.2000 (Amp 4) Ch. 1 & 3	2 per side
Sub (C)	1 x Fohhn PS-800	Fohhn D4.1000 (Amp 2) Ch. 1	
Front Fills	2 x Fohhn AT-10	Fohhn MA-4 600 (Amp 1) Ch. 1 & 2	
Top Fills	2 x Fohhn XT-22	Fohhn D4.2000 (Amp 3) Ch. 3 & 4	Hung from balcony truss
Circle Delays	2 x Fohhn XT-22	Fohhn D4.2000 (Amp 3) Ch.1 & 2	

Dimension & Plans

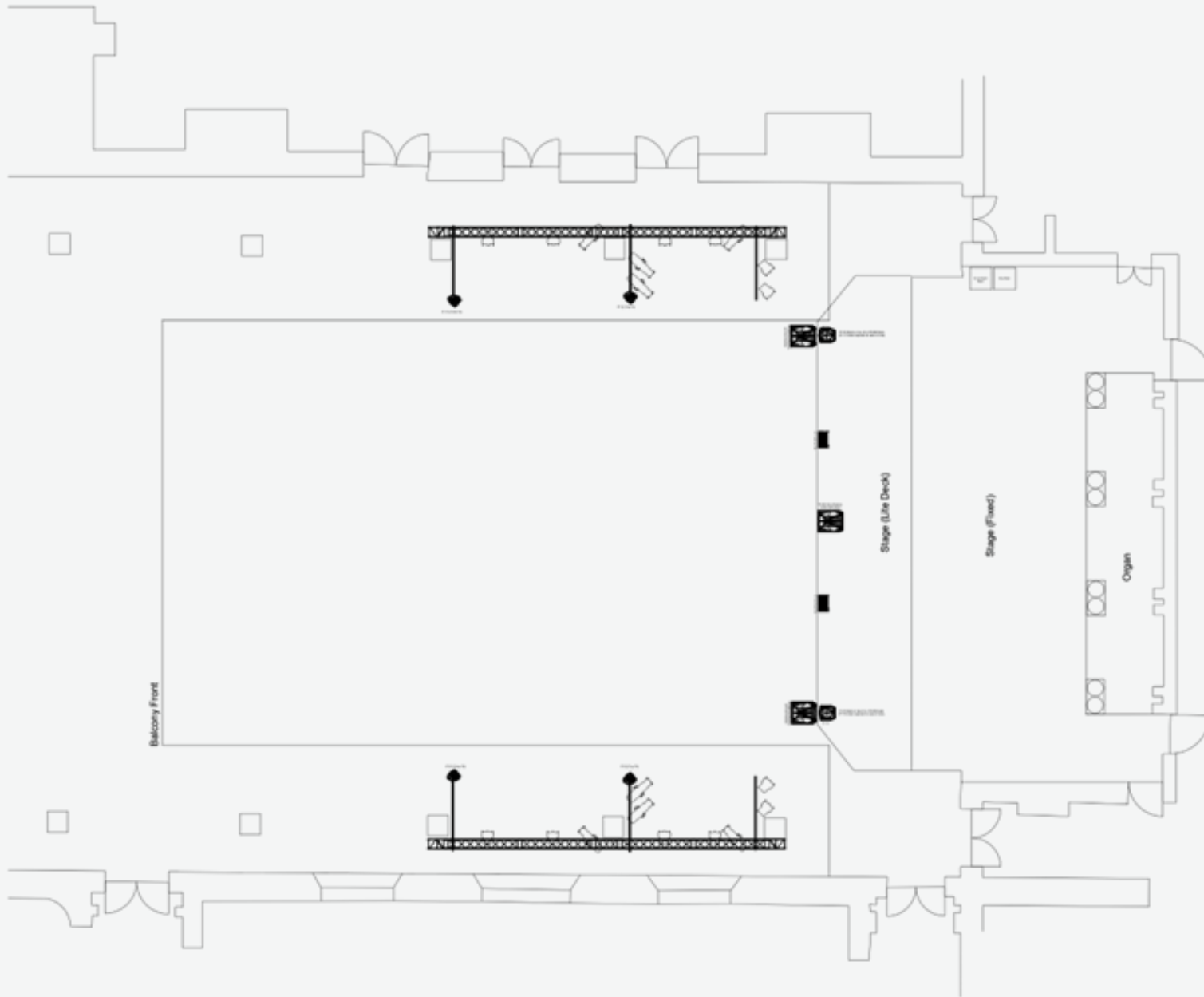

Drawn By: Callum Graham t: 07585 112144 e: callum.graham.work@gmail.com		
Any crucial measurements should be checked in person. Drawing has been taken from an original building drawing (PDF).		
This represents visual concepts & construction suggestions only. It does not replace the knowledge and advice of a licensed structural engineer. The designer is unqualified to determine the structural appropriateness of this design and will not assume responsibility for improper engineering or use.		
Venue: Lancaster Town Hall Ashton Hall		
Address: Dalton Square Lancaster LA1 1PJ		
Title: Technical Layout (Stage)		
Date:	25/09/25	Scale: 1:100 @A3
Drawn By: Callum Graham		
Drawing No:	1 of 1	Rev: 1

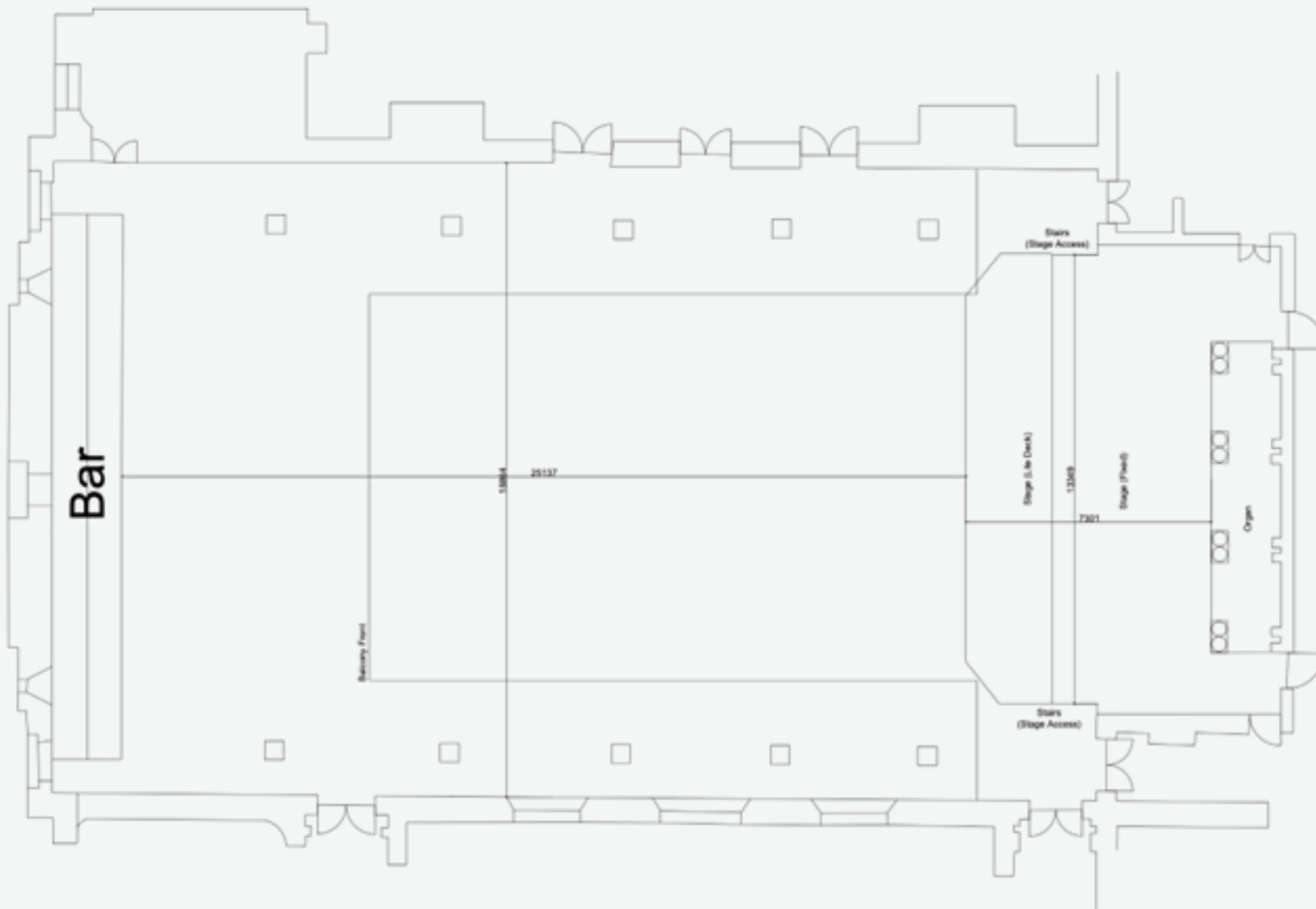

Drawn By: Callum Graham t: 07585 112144 e: callum.graham.work@gmail.com		
Any crucial measurements should be checked in person. Drawing has been taken from an original building drawing (PDF).		
This represents visual concepts & construction suggestions only. It does not replace the knowledge and advice of a licensed structural engineer. The designer is unqualified to determine the structural appropriateness of this design and will not assume responsibility for improper engineering or use.		
Venue: Lancaster Town Hall Ashton Hall		
Address: Dalton Square Lancaster LA1 1PJ		
Title: Room Dimensions		
Date:	25/09/25	Scale: 1:125 @A3
Drawn By: Callum Graham		
Drawing No:	1 of 1	Rev: 1