

[Insert name and address of relevant licensing authority and its reference number (optional)]
LANCASTER CITY COUNCIL
Licensing Team, The Town Hall, Marine Road, Morecambe, LA4 5AF

Application for a Minor Variation to a Premises Licence or Club Premises Certificate under the Licensing Act 2003

PLEASE READ THE FOLLOWING INSTRUCTIONS FIRST

Before completing this form please read the Guidance Notes at the end of the form, especially Note 1.
If you are completing this form by hand please write legibly in block capitals. In all cases ensure that your answers are inside the boxes and in black ink. Use additional sheets if necessary.
Once completed please send your application to the relevant licensing authority. You may wish to keep a copy of the completed form for your records.

The Craft Union Pub Company Limited

(Insert name(s) of applicant)

being the premises licence holder(s)/club holding a Club Premises Certificate, apply to vary a premises licence under section 41A/club premises certificate under section 86A of the Licensing Act 2003 for the premises described in Part 1 below.

Part 1 - Premises details

Postal address of premises (or, if none, ordnance survey map reference or description)
The Chieftain
24 Peddler Street

Post town Morcombe

Postcode LA4 5DZ

Telephone number at premises (if any)

[Premises licence number][Club Premises Certificate number]

LAPLWA0243

Brief description of premises (Please see Guidance Note 2)

Public House

Part 2 - Applicant Details

[I am][We are] the [premises licence holder][Club Premises Certificate holder]. (Please delete as appropriate)

Contact phone number in working hours (if any)

Applicant Postal address IF DIFFERENT FROM PREMISES ADDRESS

[REDACTED]

Post town

[REDACTED]

Postcode

[REDACTED]

Please provide email address if you would prefer us to contact you by email (optional)

Part 3 - Proposed variation(s)

Please tick

Do you want the proposed variation to have effect as soon as possible? Yes No

DDMMYYYY

If not, from what date do you want the variation to take effect?

Do you want the proposed variation to have effect in relation to the introduction of the late night levy? (Please see Guidance Note 3) Yes No

Please describe the proposed variation(s) in detail in the box below and explain why you consider that they could not have an adverse effect on the promotion of any of the licensing objectives (See Guidance Note 1). This should include whether new or increased levels of licensable activities will be taking place indoors or outdoors (indoors may include a tent):

Details of proposed variation(s) (Please see Guidance Note 4)

TO PERMIT ALTERATIONS AND TO AMEND THE PLAN THAT ATTACHES TO THE PREMISES LICENCE IN ACCORDANCE WITH THE PLAN SUBMITTED TO THE LICENSING AUTHORITY. THE PROPOSED ALTERATIONS CONSIST OF THE FOLLOWING:-

Internal refurbishment with changes to fixed seating.

IN VIEW OF THE NATURE OF THE PROPOSED VARIATION IT WILL NOT HAVE AN ADVERSE EFFECT ON THE PROMOTION OF THE LICENSING OBJECTIVES.

Details of proposed variation(s) (Continued)

Part 4 - Operating Schedule

Please tick those parts of the Operating Schedule which would be subject to change if this application to vary was successful.

Provision of regulated entertainment (please read Guidance Note 5)

Please tick all that apply

- a. plays
- b. films
- c. indoor sporting events
- d. boxing or wrestling entertainment
- e. live music
- f. recorded music
- g. performances of dance
- h. anything of a similar description to that falling within (e), (f) or (g)

Provision of late night refreshment

Supply of alcohol

(Note that this can only relate to reducing licensed hours, or moving them without any overall increase between 7am and 11pm)

Please tick to indicate you have enclosed the following:

I have enclosed the premises licence/Club Premises Certificate

I have enclosed the relevant part of the premises licence/
Club Premises Certificate

I have included a copy of the plan
(this is necessary if the proposed variation will affect the layout)

If you have not ticked one of the previous three boxes, please explain why in the box below.

Reasons why you have not enclosed the premises licence/Club Premises Certificate or relevant parts.

Any further information to support your application. (See Guidance Note 6)

CHECKLIST:

Please tick to indicate agreement

- I have made or enclosed payment of the fee; or
- I have not made or enclosed payment of the fee because this application has been made in relation to the introduction of the late night levy.
- I have enclosed the plan, if appropriate, of the premises in scale [1mm to 100mm], unless otherwise agreed with the licensing authority.
- I have enclosed the premises licence/Club Premises Certificate or relevant part of it or provided an explanation.
- I understand that if I do not comply with the above requirements my application will be rejected.
- I understand that I must now advertise my application for a continuous period beginning on the first working day after the day on which the application was given to the relevant licensing authority and ending at the expiry of the ninth consecutive working day after that day.

IT IS AN OFFENCE, UNDER SECTION 158 OF THE LICENSING ACT 2003, TO MAKE A FALSE STATEMENT IN OR IN CONNECTION WITH THIS APPLICATION. THOSE WHO MAKE A FALSE STATEMENT MAY BE LIABLE ON SUMMARY CONVICTION TO A FINE OF ANY AMOUNT.

Part 5 - Signatures and Contact Details

(See Guidance Note 7)

Premises Licence: Signature of applicant (the current premises licence holder) or applicant's solicitor or other duly authorised agent (see Guidance Note 8). If signing on behalf of the applicant, please state your name and in what capacity you are authorised to sign:

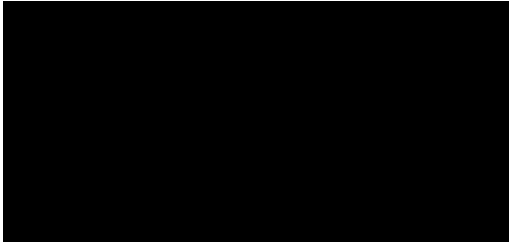
Signature	
Date	
Capacity	



Where the premises licence is jointly held, signature of 2nd applicant (the current premises licence holder) or 2nd applicant's solicitor or other authorised agent (see Guidance Note 9). If signing on behalf of the applicant, please state in what capacity.

Signature	
Date	
Capacity	

Where the premises are a club

I (insert full name) _____ make this application on behalf of the club and have authority to bind the club.

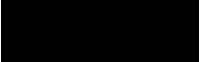
Signature	
Date	
Capacity	

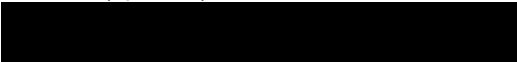
Contact name (where not previously given) and address for correspondence associated with this application (see Guidance Note 10) 	
Post town	Postcode 
Telephone number (if any) 	If you would prefer us to correspond with you by email your email address (optional) 

Notes for Guidance

1. General Note: The minor variations process can only be used for variations that could have no adverse impact on the promotion of any of the four licensing objectives. (These are: the prevention of crime and disorder; public safety; the prevention of public nuisance; and the protection of children from harm.)

It cannot be used to:

- extend the period for which the licence has effect;
- vary substantially the premises to which it relates;
- specify, in a premises licence, an individual as the designated premises supervisor;
- add the sale by retail or supply of alcohol as an activity authorised by a licence or certificate;
- authorise the sale by retail or supply of alcohol at any time between 11pm and 7am;
- authorise an increase in the amount of time on any day during which alcohol may be sold by retail or supplied;
- include the alternative licence condition referred to in section 41D(3) of the Licensing Act 2003 in a premises licence.

2. Description of premises: For example the type of premises, its general situation and layout and any other information which could be relevant to the licensing objectives. This should include any activities in or associated with the use of the premises which may give rise to concern in respect of children regardless of whether you intend children to have access to the premises, for example (but not exclusively) nudity or semi-nudity, films for restricted age groups, the presence of gaming machines etc.

3. You do not have to pay a fee if the only purpose of the variation for which you are applying is to avoid becoming liable to the late night levy.

4. Give full details of all the proposed variation(s). Failure to provide sufficient information may lead to the refusal of your application. Details should include a description of the proposed variation(s) in terms as precise as possible. If you are not precise, the licensing authority may decide that the changes you propose would be potentially broader in scope than you intend and reject your application as not being a 'minor' variation. You should also include a statement about why you consider the variation proposed could not have an impact on the licensing objectives listed in section 4(2) of the Act. You should cover each of the objectives that could possibly apply to your proposal (or if more than one, to each proposal) and say why you think there could be no adverse impact on that objective. Your application will be assisted by including as much information as you can about this. **(However, there is a box at the end of the form for 'further information', and this should be used for any relevant background information not directly related to the variation.)** Relevant information includes:

a) **Variations to licensable activities/licensing hours** (all timings should be given in 24 hour clock e.g. 16.00. Only give details for the days of the week when you intend the premises to be used for the activity), such as:

- Whether new or increased levels of licensable activities will be taking place indoors or outdoors (indoors may include a tent);
- Relevant further details, for example whether music will be amplified or unamplified;
- Standard days and timing when the activity will take place, including start and finish times;
- Any seasonal variations in timings, e.g. additional days during the summer; and
- Non-standard timings, e.g. where you wish the activity to go on longer on a particular day such as Christmas Eve.

b) **Variations to premises/club layout**: If you are applying for a variation to the layout of your premises, you must include a revised plan. You should be aware that your application is likely to be refused if the proposed variation could:

- increase capacity for drinking on the premises;
- affect access between the public part of the premises and the rest of the premises or the street or public way, e.g. block emergency exits or routes to emergency exits; or
- impede the effective operation of a noise reduction measure.

c) **Revisions, removals and additions of conditions:** The minor variation process may be used to remove conditions which are out of date or invalid and to revise conditions which are unclear (as long as the intention and effect remains the same). It can also be used to add a new condition volunteered by the applicant or mutually agreed between the applicant and a responsible authority, such as the police or the environmental health authority (subject to impact on the licensing objectives).

d) **Variations to opening hours:** Details of any changes to hours when the premises or club is open to the public.

5. In terms of specific regulated entertainments please note that:

- Plays: no licence is required for performances between 08:00 and 23.00 on any day, provided that the audience does not exceed 500.
- Films: no licence is required for 'not-for-profit' film exhibition held in community premises between 08.00 and 23.00 on any day provided that the audience does not exceed 500 and the organiser (a) gets consent to the screening from a person who is responsible for the premises; and (b) ensures that each such screening abides by age classification ratings.
- Indoor sporting events: no licence is required for performances between 08.00 and 23.00 on any day, provided that the audience does not exceed 1000.
- Boxing or Wrestling Entertainment: no licence is required for a contest, exhibition or display of Greco-Roman wrestling, or freestyle wrestling between 08.00 and 23.00 on any day, provided that the audience does not exceed 1000. Combined fighting sports - defined as a contest, exhibition or display which combines boxing or wrestling with one or more martial arts - are licensable as a boxing or wrestling entertainment rather than an indoor sporting event.
- Live music: no licence permission is required for:
 - a performance of unamplified live music between 08.00 and 23.00 on any day, on any premises.
 - a performance of amplified live music between 08.00 and 23.00 on any day on premises authorised to sell alcohol for consumption on those premises, provided that the audience does not exceed 500.
 - a performance of amplified live music between 08.00 and 23.00 on any day, in a workplace that is not licensed to sell alcohol on those premises, provided that the audience does not exceed 500.
 - a performance of amplified live music between 08.00 and 23.00 on any day, in a church hall, village hall, community hall, or other similar community premises, that is not licensed by a premises licence to sell alcohol, provided that (a) the audience does not exceed 500, and (b) the organiser gets consent for the performance from a person who is responsible for the premises.
 - a performance of amplified live music between 08.00 and 23.00 on any day, at the non-residential premises of (i) a local authority, or (ii) a school, or (iii) a hospital, provided that (a) the audience does not exceed 500, and (b) the organiser gets consent for the performance on the relevant premises from: (i) the local authority concerned, or (ii) the school or (iii) the health care provider for the hospital.
- Recorded Music: no licence permission is required for;
 - any playing of recorded music between 08.00 and 23.00 on any day on premises authorised to sell alcohol for consumption on those premises, provided that the audience does not exceed 500.
 - any playing of recorded music between 08.00 and 23.00 on any day, in a church hall, village hall, community hall, or other similar community premises, that is not licensed by a premises licence to sell alcohol, provided that (a) the audience does not exceed 500, and (b) the organiser gets consent for the performance from a person who is responsible for the premises.
 - any playing of recorded music between 08.00 and 23.00 on any day, at the non-residential premises of (i) a local authority, or (ii) a school, or (iii) a hospital, provided that (a) the audience does not exceed 500, and (b) the organiser gets consent for the performance on the relevant premises from: (i) the local authority concerned, or (ii) the school proprietor or (iii) the health care provider for the hospital.
- Dance: no licence is required for performances between 08.00 and 23.00 on any day, provided that the audience does not exceed 500. However, a performance which amounts to adult entertainment remains licensable.
- Cross activity exemptions: no licence is required between 08.00 and 23.00 on any day, with no limit on audience size for:
 - any entertainment taking place on the premises of the local authority where the entertainment is provided by or on behalf of the local authority;
 - any entertainment taking place on the hospital premises of the health care provider where the entertainment is provided by or on behalf of the health care provider;
 - any entertainment taking place on the premises of the school where the entertainment is provided by or on behalf of the school proprietor; and
 - any entertainment (excluding films and a boxing or wrestling entertainment) taking place at a travelling circus, provided that (a) it takes place within a moveable structure that accommodates the audience, and (b) that the travelling circus has not been located on the same site for more than 28 consecutive days.

6. Further information: You should use this box to provide any additional evidence to support your claim that the proposed variation is 'minor' and could not have an adverse impact on the promotion of the licensing objectives.

7. Signatures: The application form must be signed.

8. Authorised agent: An applicant's agent (e.g. solicitor) may sign the form on their behalf and, in so doing, will be confirming that they have actual authority to do so.

9. 2nd Applicant: Where there is more than one applicant, both applicants or their respective agents must sign the application form.

10. This is the address which we shall use to correspond with you about this application. This might not be the same as the address of the premises or applicant, but these addresses must also be provided.

GENERAL
 - ASBESTOS, FRA, ROOF, ELECTRICAL AND MECHANICAL & VENTILATION SURVEYS REQUIRED.
NOTE:
 - CHECK WIFI, CCTV
 - ALARM, FIRE ALARMS, EMERGENCY LIGHTING TO BE CHECKED
 - REUPHOLSTER EXISTING FIXED SEATING
 - INTERNAL REDECORATION THROUGHOUT AS PER HARRISON INCE SPEC.
 - NEW DRINKS SHELVES TO ALL AWPS.
 - SOME NEW BRIC-A-BRAC. BRIC A BRAC TO BE RELATED TO LOCAL AREA.
 - ALLOW FOR NEW POSTER FRAMES
 - ALLOW FOR NEW LIGHT FITTINGS
 - ALLOW COST FOR NEW IRONMONGERY
 - ALLOW FOR NEW FLOORING AS SHOWN ON PLAN
 - ALLOW FOR NEW CURTAINS/BLINDS TO ALL CUSTOMER AREA WINDOWS
 - MIX OF NEW AND REUPHOLSTERED FURNITURE TO ALL AREAS

BAR
 - DISPENSE UPGRADE
 - RETAIN EXISTING TILL POSITIONS, NEW TILL SHROUDS
 - ALLOW TO POLISH THE BAR TOP
 - NEW KARNDEAN BAR WALK
 - REMOVE POSTS, GLASS PANELS AND FRAMES AND METAL RAILINGS ABOVE BAR.
 - PAINT BAR FRONT
 - NEW SMALL PENDANTS

BACK BAR:
 - ALLOW TO AMEND EXISTING BACK BAR SECTIONS. NEW ILLUMINATED BOTTLE SHELF TO REAR OPTICS SECTION.
 - ROUND OFF CORNERS OF END SECTION
 - ALLOW FOR NEW LED TO BACK BAR
 - RETAIN EXISTING TV ON BACK BAR
 - ALLOW TO MOVE JAGER MACHINE TO REAR OF BAR
 - ALLOW TO RE INSTALL EXISTING BAR FLAP. WATER FEED WILL NEED TAPPING OFF.

MECHANICAL
 - ENSURE VENTILATION TO CUSTOMER AREA IS ADEQUATE
 - CHECK VENTILATION TO EXISTING TOILETS
 - CHECK HEATING SYSTEM & BOILER
 - ALLOW FOR AMENDMENTS TO HEATING SYSTEM
 - RETAIN EXISTING ELECTRICAL FIRE.

AV WORKS - INTERNAL
 - HD UPGRADE NOT REQUIRED (ALL TV'S ARE NEW)
 - ENSURE CORRECT POSITION OF SOUND LEISURE
 - RELOCATE EXISTING EFFECTS LIGHTING
 - ENSURE CORRECT POSITION OF THE DJ POINT
 - RETAIN TV'S AND SPEAKERS.
 - CHECK CCTV IF REQUIRED

ELECTRICAL WORKS - INTERNAL
 - ELECTRICIAN TO CONFIRM ALL AREAS ARE ZONED AND ALL LIGHT FITTINGS DIMMABLE
 - ALLOW FOR NEW DIMMER PANEL
 - ALL ITEMS AS PART OF NEW FRA REPORT TO BE COMPLETED AS PART OF WORKS
 - ALLOW FOR NEW DOUBLE SOCKETS (SOME SOCKETS DO NOT WORK) FOR FIXED SEATING
 - CHECK EXTERNAL HEATERS IF REQUIRED
 - GLASS WASH REQUIRES INSTALLATION OF 30 AMP POWER SUPPLY

Do not scale from this drawing. All dimensions to be checked on site prior to manufacture and construction. This drawing is the property of Harrison Ince Holdings Limited and should not be reproduced without permission. All discrepancies to be brought to the attention of the architect immediately. This drawing is to be read in conjunction with the specification / bill of quantities and related drawings.

REVISIONS			
-	FIRST ISSUE	19.12.2023	LB
A	NEW BRIEF AUGUST 24	06.08.2024	HB
B	CORRECTED	06.08.2024	HB
C	UPDATED AFTER SKETCH CALL	28.08.2024	HB
D	REVISED AFTER PRE COM	28.10.2024	LB

EDA		
ROOM	AREA m ²	AREA SqFT
CUSTOMER AREA	147	1583
TOTAL INTERNAL EDA	147	1580
EXTERNAL AREA EDA	42	462
COVERS		
EXISTING INTERNAL COVERS	58	
PROPOSED INTERNAL COVERS	72	
EXISTING EXTERNAL COVERS	18	
PROPOSED INTERNAL COVERS	36	

COLOUR KEY	
NAME	COLOUR
EXISTING FURNITURE - TO BE REFURBISHED	
NEW FURNITURE	
EXISTING FURNITURE - NO CHANGES	

FINISHES AND FITTINGS	
NAME	COLOUR
NEW WALLPAPER	
NEW DIGITAL PRINT	
NEW PANELING REF.	
NEW DOOR REF.	ND

LIGHTING KEY	
NAME	COLOUR
RED SYMBOL = NEW LIGHT FITTING OR POSITION	
BLACK SYMBOL = EXISTING FITTING IN EXISTING POSITION	

EXISTING FLOOR FINISHES KEY INTERNAL	
NAME	TYPE
CARPET REF: CALDERDALE ESSENCE NUTMEG	
TIMBER FLOORING REF: EXISTING	
KARNDEAN EXISTING	
AMTICO SPACIA BLACK WHITE MARBLE ENHANCED +36 304.8X304.8.	
NEW ALTRO TIMBERSAFE FLOORING REF: URBAN CHERRY	
NEW BARRIER MATTING	

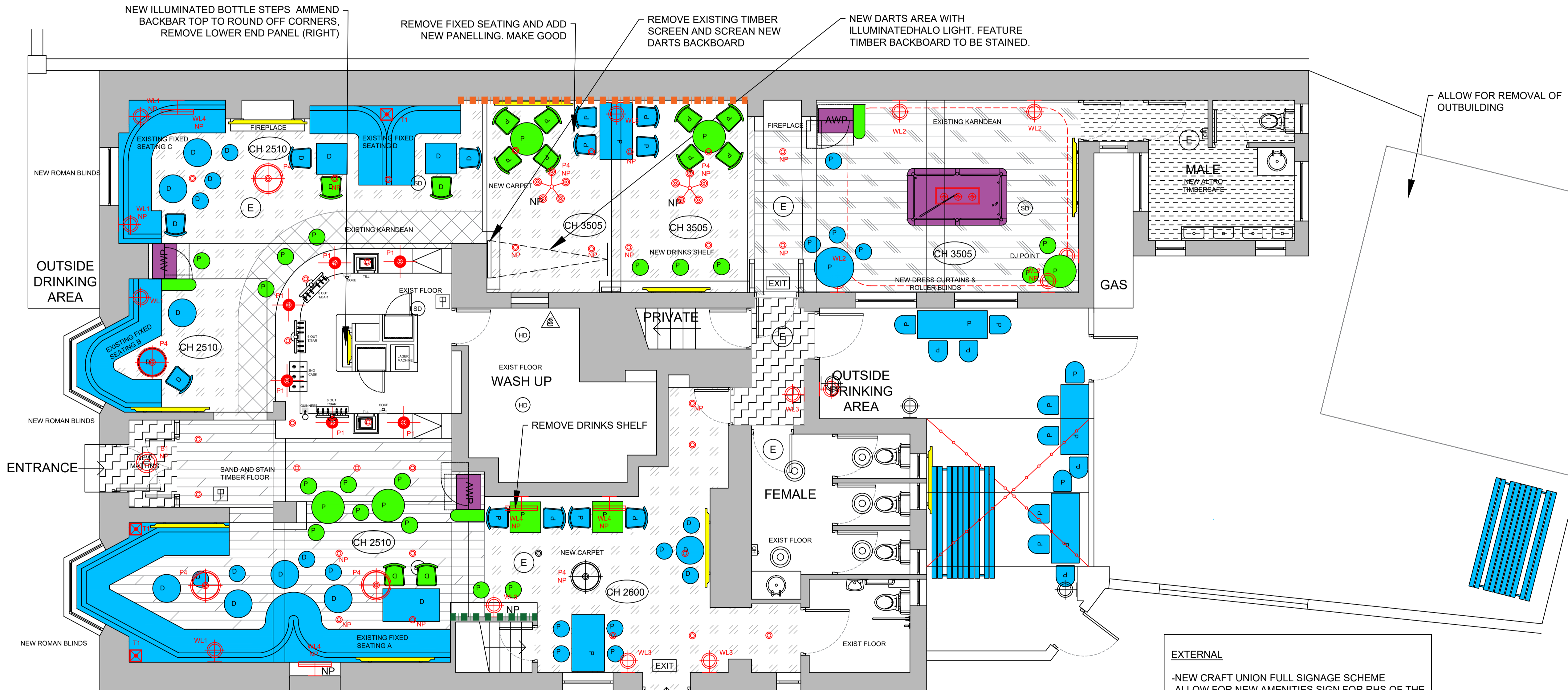

PROPOSED GROUND FLOOR PLAN
 Scale 1:50

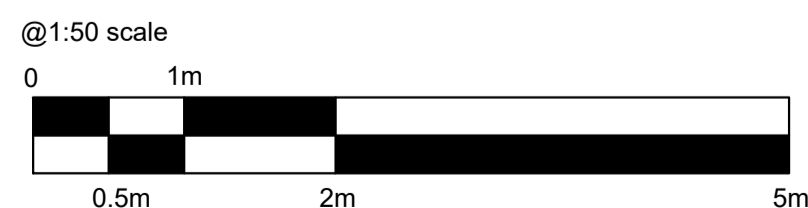

DDA TOILET
 - FULL DECORATIONS
 - NEW MIRRORS
 - NEW TILING BEHIND SINK

BEER GARDEN
 - ALLOW FOR NEW FESTOON LIGHTING + POST
 - ALLOW FOR EXTERNAL WALL LIGHTS
 - JET WASH WALLS AND PAVING
 - WEEDING (TOP OF WALLS)
 - TIDY WIRING/CABLES
 - REMOVE RHS BLUE CANOPY AND MAKE GOOD.

GENTS TOILET
 - ALLOW FOR REDECORATION
 - NEW SOAP DISPENSERS
 - ALLOW FOR ALTRO TIMBER SAFE FLOORING
 - NEW MIRRORS
 - CLEAN LIGHT FITTINGS
 - NEW RADIATOR W/ SHELF
 - NEW IRONMONGERY IF REQUIRED
 - CHECK EXTRACTION FULLY OPERATIONAL
 - DRAINAGE SURVEY REQUIRED
 - RETAIN URINAL TROUGH REMOVE STEP
 - ASSES LEAK IN GENTS AND TIGHTEN/REPLACE URINAL PIPES
 - NEW VINYL TO GENTS TOILETS
 - NEW TOILET SEATS
 - NEW PERSPEX PANEL UNDER HAND DRYERS

LADIES TOILET
 - ALLOW FOR REDECORATION
 - NEW SOAP DISPENSERS
 - NEW MIRRORS
 - CLEAN LIGHT FITTINGS
 - NEW RADIATOR
 - NEW IRONMONGERY IF REQUIRED
 - CHECK EXTRACTION FULLY OPERATIONAL
 - DRAINAGE SURVEY REQUIRED
 - ADD SKIRTING TO CUBICLE FEET
 - NEW TOILET SEATS
 - NEW PERSPEX PANEL UNDER HAND DRYERS

EXTERNAL
 - NEW CRAFT UNION FULL SIGNAGE SCHEME
 - ALLOW FOR NEW AMENITIES SIGN FOR RHS OF THE PUB TO HAVE 'BEER GARDEN' ON IT.
 - NEW HANGING SIGN WITH THE CHIEF (NAVAL) "A" BOARD
 - REMOVE ALL ITEMS FROM ROOF CANOPY INCLUDING LION STATUES ETC.
 - RETAIN THE "CHIEF" - REFURBISH
 - NEW 'WELCOME' SIGN ABOVE FRONT DOOR.
 - FULL REDECORATION TO 2 ELEVATIONS INC. RENDER, RAINWATER GOODS, WINDOW FRAMES & DOORS AS PER SIGNAGE SCHEME .
 - NEW CILLS TO GF
 - EXTERNAL REPAIRS AS NECESSARY
 - REMOVE SHUTTERS
 - PAINT STONE LINTELS, SILLS, FRAMES IN COLOUR TO CONTRAST RENDER
 - REPAINT STEP EDGES
 - ALLOW TO REPLACE BLOWN GLAZING UNITS

HARRISON INCE
 ARCHITECTS INTERIOR DESIGNERS

CLIENT	
PROJECT	
TITLE	
DATE	DECEMBER 2024
SCALE	1:50 @ A1
JOB NO.	CU063
DWG. NO.	AL01 D
DRAWN	CAD/LB
CHECKED	

SUN HOUSE
 24 LITTLE PETER STREET
 100FT HALL
 MANCHESTER
 M15 4PS
 TEL: 0161 236 3650
 EMAIL: enquiries@harrison-ince.co.uk